

合格证  
QC PASS

godox fotichaestli.ch

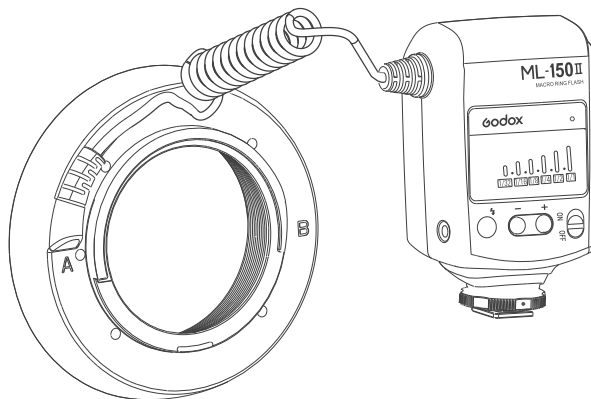

Wechat  
Official Account  
神牛微信公众号

深圳市神牛摄影器材有限公司

地址: 深圳市宝安区福海街道塘尾社区福川工业区厂房2栋 电话: 0755-29609320(8062)

传真: 0755-25723423 邮箱: godox@godox.com

GODOX Photo Equipment Co.,Ltd.

Add.: Building 2, Yaochuan Industrial Zone, Tangwei Community, Fuhai Street, Bao'an District,

Shenzhen 518103, China Tel: +86-755-29609320(8062) Fax: +86-755-25723423

E-mail: godox@godox.com

godox.com

Made in China | 705-ML1520-00



# ML-150 II

微距环形闪光灯  
Macro Ring Flash

使用手册  
Instruction Manual

## Name of Parts

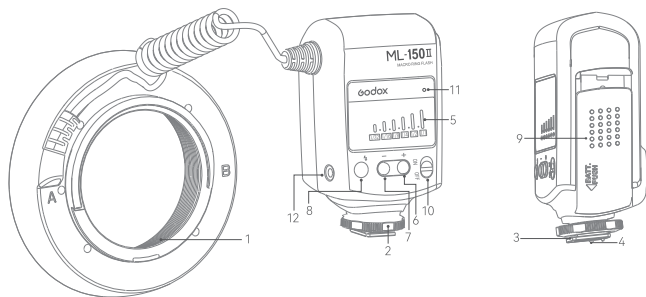

1. Ring Flash Head
2. Locking Ring
3. Hot Shoe
4. Hot Shoe Contact

5. Output Level Indicator
6. Power + Button
7. Power - Button
8. Test Button

9. Battery Cover
10. Power Switch
11. Charging Indicator
12. PC Sync Socket

## What's Inside

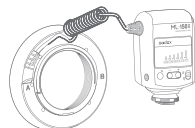

Macro Ring Flash \*1



Adapter Rings Kit AR-R Kit (49mm, 52mm, 55mm, 58mm, 62mm, 67mm, 72mm, 77mm) \*1



Instruction Manual\*1

## Operation Instruction

### Battery Installation

1. Open the battery cover

Slide the battery cover along the arrow direction and then open it by thumb.

2. Insert the batteries

Install the batteries according to the direction indicated in the battery holder and make sure the + and - battery contacts are correctly inserted at the battery compartment.

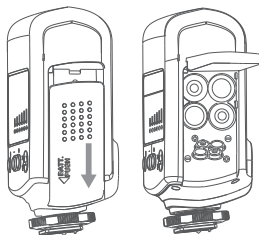

3. Close the battery cover

Slide the battery cover along the arrow direction and slide it back in place. The battery cover will be locked when there is a "click" sound.

Note: Take care of the hot battery when changing them after continuous flashes.  
Take out of the battery when idle in case the battery leakage damages the flash unit.

## Mounting Macro Ring Flash on the Camera

### 1. Attach the Control Unit on the Camera

- Twist the mounting lock to loosen it.
- Slide the mounting foot of control unit into the camera's hot shoe completely.
- Twist the mounting lock to tighten it.

Tip: To remove the flash, loosen the fixed knob and slide it out of the hot shoe of camera.

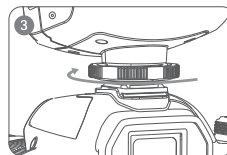
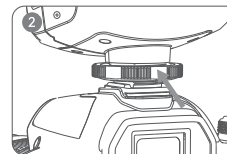
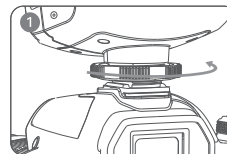

### 2. Attach the Flash Ring on the Camera.

- 8 types of adapter rings available to suit the camera lens: 49mm, 52mm, 55mm, 58mm, 62mm, 67mm, 72mm and 77mm.
- Choose the adapter ring needed for your camera and attach to the camera lens.
- Mount the flash ring onto the adapter ring.

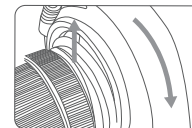
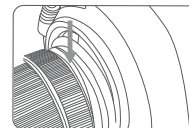
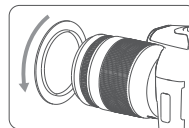

## Power Switch

Switch the power switch to ON position to power on.  
Slide the power switch to OFF position to power off.

## Charging Indicator Instruction

Turn the flash on, the charging indicator turns red and it is ready to shoot.  
If the charging indicator lamp blinks red in every 1s, it indicates low battery. In such case, please replace the batteries.

## Output Control

The flash unit has 6 stops of power output control from 1/32 to 1/1 in 1/2 stop of increment.  
Press + button to increase power by 1/2 stop, otherwise, press - button to decrease power by 1/2 stop.

## Synchronization Function

The flash and camera will trigger synchronously by using a PC sync cord to connect the sync terminals of the camera and the flash together.  
Note: PC sync cord is sold separately.

## Power Saving Function

The flash unit is equipped with power saving mode. When idle for about 30 minutes, it will enter deeper sleep state automatically to save power. To restart the unit, just press any button.

## Protection Function

To prevent the flash head from getting too hot and damage, please do not flash over 50 times when in power level 1/1. Please cool down the flash unit for at least 5 minutes.  
The over-temperature protection function will be activated if you continue to flash after 50 times. In this case, the charging time will turn to 7s. Please cool down the flash unit around 5 minutes and it will turn to normal state.

Number of flashes that will activate over-temperature protection:

Power Output	Flashes (Approx.)
1/1	50
1/2 +0.5	75
1/2	100
1/4 +0.5	150
1/4	200
1/8 +0.5	300
1/8	400
1/16 +0.5	500
1/16	600
1/32 +0.5	700
1/32	800

## Systematic Over-temperature Protection

When the inner circuit is over-heating, which indicates over use of the flash unit, the inner circuit will shut down power automatically. The flash unit will turn to normal state after the inner circuit is cooled down (about 5 minutes).

## Technical Data

Model	ML-150II
Power Supply	4•AA alkaline batteries
Guide Number	GN12(ISO 100, in meter)
Flash Times	300—1000 times (AA alkaline batteries used)
Recycle Time	Approx. 0.1~2s (AA alkaline batteries used)
CCT	5800K±200K
Flash Duration	1/200S—1/5000S
Dimension	Controller: 116•71•48mm
	Flash Head: 132•132•32mm
Net Weight	0.42kg

## FCC Statement

This device complies with part 15 of the FCC Rules. Operation is subject to the following two conditions:

- (1) This device may not cause harmful interference, and
- (2) this device must accept any interference received, including interference that may cause undesired operation.

Any Changes or modifications not expressly approved by the party responsible for compliance could void the user's authority to operate the equipment.

Note: This equipment has been tested and found to comply with the limits for a Class B digital device, pursuant to part 15 of the FCC Rules. These limits are designed to provide reasonable protection against harmful interference in a residential installation. This equipment generates uses and can radiate radio frequency energy and, if not installed and used in accordance with the instructions, may cause harmful interference to radio communications. However, there is no guarantee that interference will not occur in a particular installation. If this equipment does cause harmful interference to radio or television reception, which can be determined by turning the equipment off and on, the user is encouraged to try to correct the interference by one or more of the following measures:

- Reorient or relocate the receiving antenna.
- Increase the separation between the equipment and receiver.
- Connect the equipment into an outlet on a circuit different from that to which the receiver is connected.
- Consult the dealer or an experienced radio/TV technician for help.

## Declaration of Conformity:

GODOX Photo Equipment Co.Ltd, hereby declares that the This equipment are in compliance with the essential requirements and other relevant provisions of EU Directive 2014/35/EU- 2014/30/EU. They are allowed to be used in all EU member state.

For more information of DoC, Please click this web link <https://www.godox.com/DOC/GoDox-ML-150IILDOC.pdf>.

## Warranty

Dear customers, as this warranty card is an important certificate to apply for our maintenance service, please fill in the following form in coordination with the seller and safe-keep it. Thank you!

Product Information	Model	Product Code Number
Customer Information	Name	Contact Number
	Address	
Seller Information	Name	
	Contact Number	
	Address	
	Date of Sale	
Note		

Note: This form shall be sealed by the seller.

### Applicable Products

The document applies to the products listed on the Product Maintenance Information (see below for further information). Other products or accessories (e.g. promotional items, giveaways and additional accessories attached, etc.) are not included in this warranty scope.

### Warranty Period

The warranty period of products and accessories is implemented according to the relevant Product Maintenance Information. The warranty period is calculated from the day (purchase date) when the product is bought for the first time. And the purchase date is considered as the date registered on the warranty card when buying the product.

### How to Get the Maintenance Service

If maintenance service is needed, you can directly contact the product distributor or authorized service institutions. You can also contact the Godox after-sale service call and we will offer you service. When applying for maintenance service, you should provide valid warranty card. If you cannot provide valid warranty card, we may offer you maintenance service once confirmed that the product or accessory is involved in the maintenance scope, but that shall not be considered as our obligation.

### Inapplicable Cases

The guarantee and service offered by this document are not applicable in the following cases: ① **The product or accessory has expired its warranty period;** ② **Breakage or damage caused by inappropriate usage, maintenance or preservation, such as improper packing, improper usage, improper plugging in/out external equipment, falling off or squeezing by external force, contacting or exposing to the improper temperature, solvent, acid, base, flooding and damp environments, etc;** ③ **Breakage or damage caused by non-authorized institution or staff in the process of installation, maintenance, alternation, addition and detachment;** ④ **The original identifying information of product or accessory is modified, alternated, or removed;** ⑤ **No valid warranty card;** ⑥ **Breakage or damage caused by using illegally authorized, nonstandard or non-public released software;** ⑦ **Breakage or damage caused by force majeure or accident;** ⑧ **Breakage or damage that could not be attributed to the product itself.** Once met these situations above, you should seek solutions from the related responsible parties and Godox

assumes no responsibility. The damage caused by parts, accessories and software that beyond the warranty period or scope is not included in our maintenance scope. The normal discoloration, abrasion and consumption are not the breakage within the maintenance scope.

## Maintenance and Service Support Information

The warranty period and service types of products are implemented according to the following Product Maintenance Information:

Product Type	Name	Maintenance Period(month)	Warranty Service Type
Parts	Circuit Board	12	Customer sends the product to designated site
	Battery	3	Customer sends the product to designated site
	Electrical parts e.g.battery charger, etc.	12	Customer sends the product to designated site
Other Items	Flash tube, power cord, sync cable,modeling lamp,lamp body, lamp cover,lockingdevice, package, etc.	No	Without warranty

Godox After-sale Service Call +86-755-29609320(8062)